

SELLWOOD MORELAND RETAIL

SECOND GENERATION RESTAURANT SPACE



FOR LEASE > 5,456 RSF

ADDRESS

7119 SE Milwaukie Avenue | Portland, OR

AVAILABLE SPACE

5,456 RSF

RENTAL RATE

Please call for details

TRAFFIC COUNTS

SE Milwaukie Ave – 10,583 ADT ('21)

SE Bybee Blvd – 8,649 ADT ('22)

HIGHLIGHTS

- Neighborhood 2nd generation restaurant space with type 1 hood, grease interceptor, walk in cooler, fully built-out bar, and all existing FF&E included.
- Meetinghouse features over 230 residential apartment units located above the ground floor retail with unique residential common area amenity space and underground residential parking.
- Join Pure Green Juice Bar and Dairy Hill Ice Cream along with these other nearby retailers: Coco and Toulouse, Fuchsia, Stars Antique Mall, Starbucks, Collage, Pizzicato, PDX Sliders, and many more.



[CLICK HERE
TO LEARN
MORE ABOUT](#)

meetinghouse



COMMERCIAL
REALTY ADVISORS
NORTHWEST LLC

Kathleen Healy 503.880.3033 | kathleen@cra-nw.com
Ashley Heichelbech 503.490.7212 | ashley@cra-nw.com

503.274.0211
www.cra-nw.com

SELLWOOD MORELAND RETAIL

7119 SE MILWAUKIE AVE

PORTLAND, OR

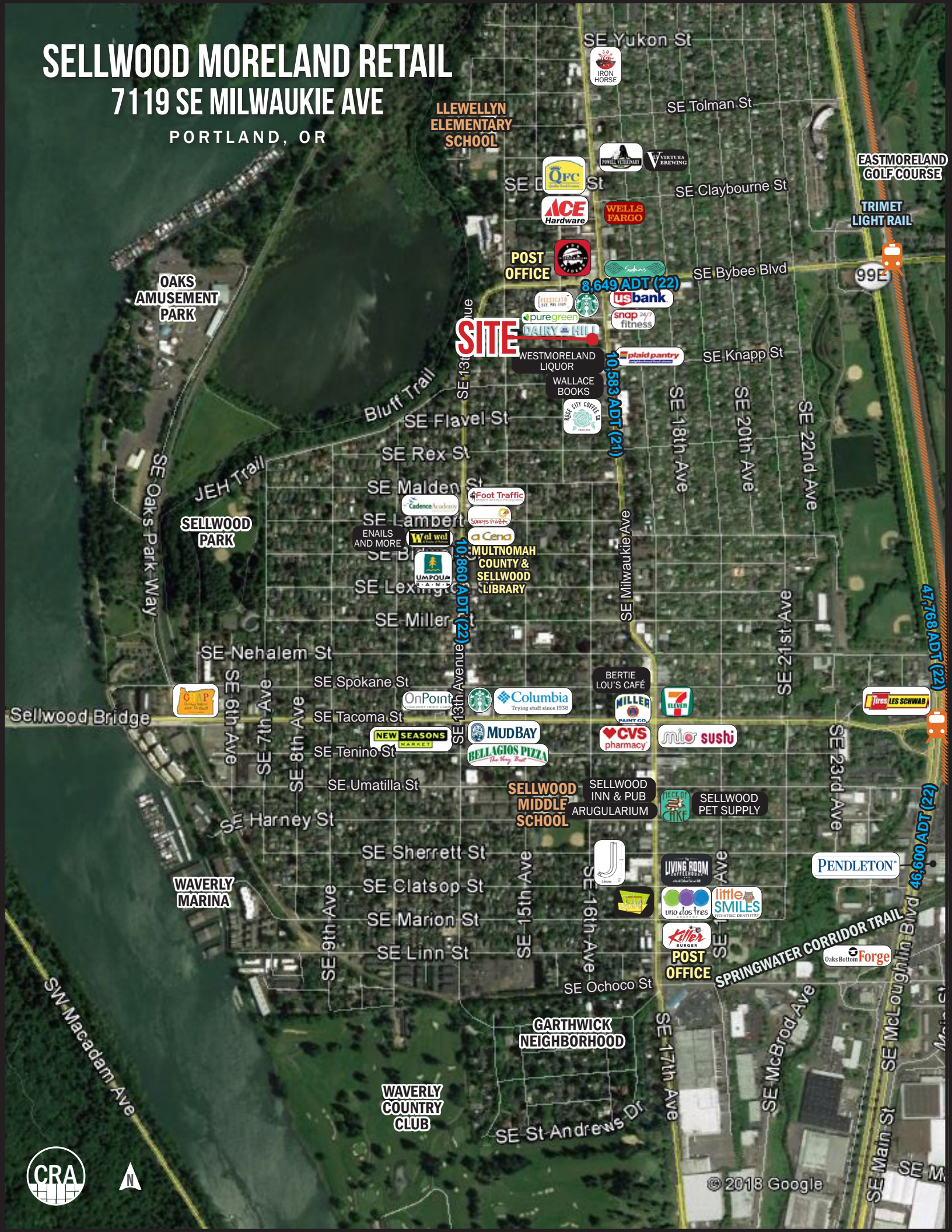

SELLWOOD MORELAND RETAIL

7119 SE MILWAUKIE AVE
PORTLAND, OR

INTERIOR IMAGES



SELLWOOD MORELAND RETAIL

7119 SE MILWAUKIE AVE
PORTLAND, OR

KITCHEN IMAGES



SELLWOOD MORELAND RETAIL
7119 SE MILWAUKIE AVE
PORTLAND, OR

OVERALL SITE PLAN

SE MILWAUKIE AVE ← →

4,319 ADT (2024)

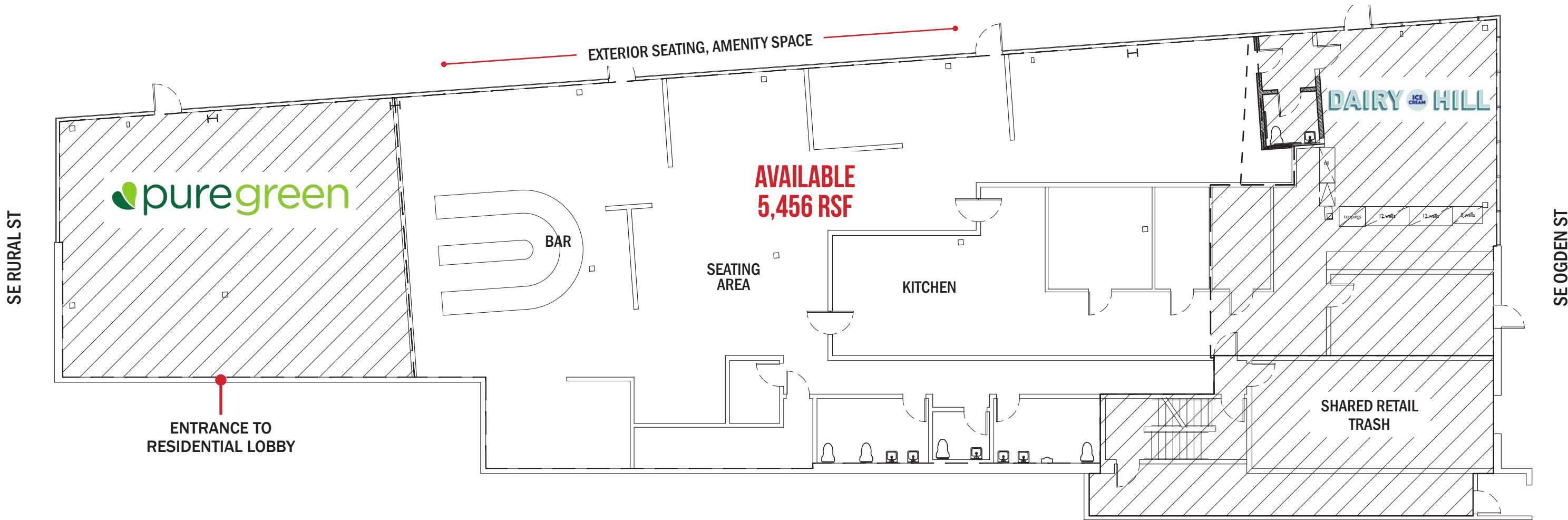

PLAN SHOWN FOR ILLUSTRATIVE PURPOSES ONLY.



SELLWOOD MORELAND RETAIL

7119 SE MILWAUKIE AVE

DEMOGRAPHIC SUMMARY

PORTLAND, OR

Source: Regis - SitesUSA (2024)	¼ MILE	½ MILE	1 MILE
Estimated Population 2024	1,858	5,884	16,304
Projected Population 2029	1,893	5,941	16,148
Average HH Income	\$155,605	\$144,572	\$143,598
Median Home Value	\$666,181	\$658,149	\$681,097
Daytime Demographics 16+	1,411	3,688	11,648
Some College or Higher	90.4%	88.0%	87.3%

\$155,605
Average Household Income
¼ MILE RADIUS

40.8
Median Age
¼ MILE RADIUS

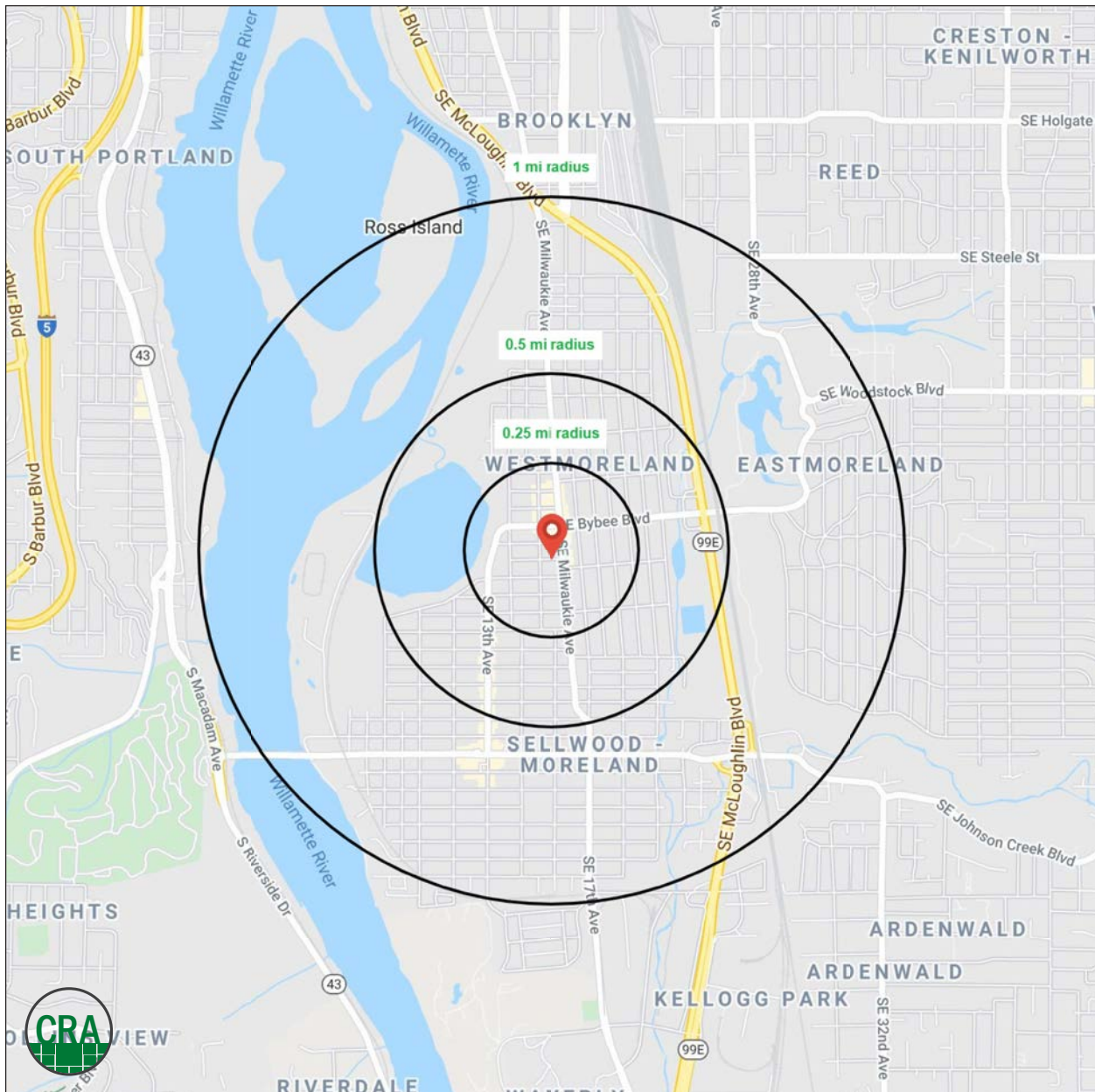

Summary Profile

2010-2020 Census, 2024 Estimates with 2029 Projections
 Calculated using Weighted Block Centroid from Block Groups



Lat/Lon: 45.4728/-122.6488

7119 SE Milwaukie Ave Portland, OR 97202	0.25 mi radius	0.5 mi radius	1 mi radius
Population			
2024 Estimated Population	1,858	5,884	16,304
2029 Projected Population	1,893	5,941	16,148
2020 Census Population	1,944	6,014	16,465
2010 Census Population	1,420	4,815	13,686
Projected Annual Growth 2024 to 2029	0.4%	0.2%	-0.2%
Historical Annual Growth 2010 to 2024	2.2%	1.6%	1.4%
2024 Median Age	40.8	41.4	40.4
Households			
2024 Estimated Households	850	2,728	7,509
2029 Projected Households	874	2,778	7,537
2020 Census Households	868	2,755	7,495
2010 Census Households	641	2,234	6,270
Projected Annual Growth 2024 to 2029	0.5%	0.4%	-
Historical Annual Growth 2010 to 2024	2.3%	1.6%	1.4%
Race and Ethnicity			
2024 Estimated White	75.3%	75.5%	73.4%
2024 Estimated Black or African American	4.7%	4.3%	4.9%
2024 Estimated Asian or Pacific Islander	10.3%	10.4%	11.4%
2024 Estimated American Indian or Native Alaskan	0.3%	0.3%	0.4%
2024 Estimated Other Races	9.4%	9.6%	10.0%
2024 Estimated Hispanic	9.2%	9.2%	9.7%
Income			
2024 Estimated Average Household Income	\$155,605	\$144,572	\$143,598
2024 Estimated Median Household Income	\$128,071	\$117,220	\$107,814
2024 Estimated Per Capita Income	\$71,256	\$67,077	\$66,366
Education (Age 25+)			
2024 Estimated Elementary (Grade Level 0 to 8)	0.6%	1.2%	1.3%
2024 Estimated Some High School (Grade Level 9 to 11)	3.2%	3.5%	2.2%
2024 Estimated High School Graduate	5.8%	7.3%	9.1%
2024 Estimated Some College	17.6%	16.7%	15.6%
2024 Estimated Associates Degree Only	5.1%	4.3%	4.3%
2024 Estimated Bachelors Degree Only	37.7%	35.6%	36.3%
2024 Estimated Graduate Degree	30.0%	31.3%	31.2%
Business			
2024 Estimated Total Businesses	207	472	1,191
2024 Estimated Total Employees	862	1,936	6,474
2024 Estimated Employee Population per Business	4.2	4.1	5.4
2024 Estimated Residential Population per Business	9.0	12.5	13.7

For more information, please contact:

ASHLEY HEICHELBECH 503.490.7212 | ashley@cra-nw.com

KATHLEEN HEALY 503.880.3033 | kathleen@cra-nw.com



KNOWLEDGE

RELATIONSHIPS

EXPERIENCE



**COMMERCIAL
REALTY ADVISORS
NORTHWEST LLC**

Licensed brokers in Oregon & Washington

 15350 SW Sequoia Parkway, Suite 198 • Portland, Oregon 97224



www.cra-nw.com



503.274.0211

The information herein has been obtained from sources we deem reliable. We do not, however, guarantee its accuracy. All information should be verified prior to purchase/leasing. View the Real Estate Agency Pamphlet by visiting our website, www.cra-nw.com/home/agency-disclosure.html. CRA PRINTS WITH 30% POST-CONSUMER, RECYCLED-CONTENT MATERIAL.